

FILL PLAN NOTES

THIS PLAN SHOWS DETAILS OF WORKS AFFECTING THE NATURAL SURFACE OF THE LAND WITHIN THE SUBDIVISION WHICH HAVE BEEN CARRIED OUT OR ARE PROPOSED TO BE CARRIED OUT PRIOR TO REGISTRATION OF THE PLAN OF SUBDIVISION, BEING FILL PLACED ON THE LAND TO THE EXTENT AND DEPTH SHOWN ON THIS PLAN.

THIS PLAN DOES NOT SHOW ANY OTHER FILL WHICH MAY HAVE BEEN PLACED ON THE LAND PRIOR TO THE CIVIL WORKS BEING UNDERTAKEN.

THIS PLAN HAS BEEN PREPARED FOR THE PURPOSE OF CONSTRUCTING SUBDIVISIONAL WORKS AND IS NOT A RECORD OF 'AS BUILT DETAILS'.

FILLING SHOWN LESS THAN 200mm DEEP IS GRADED OR SPREAD OVER ALLOTMENTS TO CORRECT MINOR SURFACE IRREGULARITIES SUCH AS FURROWS ETC AND LOT GRADING.

IRRESPECTIVE OF THE DEPTH OF FILLING FOUNDATIONS MUST BE DESIGNED AND CONSTRUCTED IN ACCORDANCE WITH A SOIL CLASSIFICATION AND REPORT PREPARED FOR THE PURPOSE AND IN ACCORDANCE WITH THE APPROPRIATE BUILDING REGULATIONS.

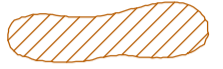
THE AREA MARKED THUS  ON THIS PLAN INDICATES FILL DEEPER THAN 200mm PLACED ON ALLOTMENTS.

THE EXTENT OF AND DEPTH OF FILL MUST BE CONFIRMED BY A PROPER GEOTECHNICAL INVESTIGATION BY AN EXPERIENCED PRACTITIONER.

PRELIMINARY COPY
 FOR DISCUSSION PURPOSES ONLY
 ISSUE DATE: 26/05/2016

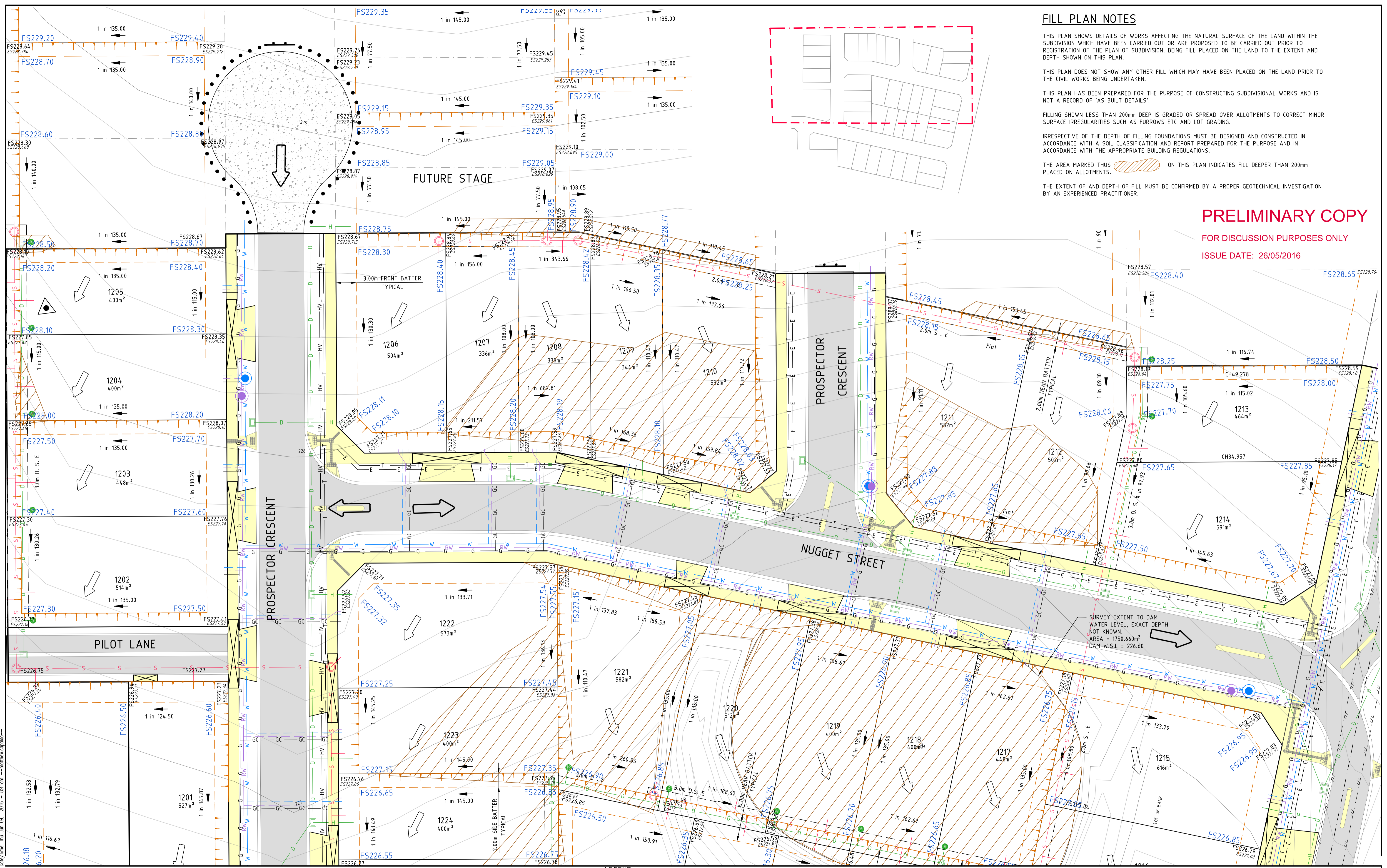

SURVEY EXTENT TO DAM WATER LEVEL, EXACT DEPTH NOT KNOWN.
 AREA = 1750.660m²
 DAM W.S.L. = 226.60

NOT TO BE USED FOR CONSTRUCTION

C	PLAN OF SUBDIVISION UPDATE	08/06/16	TL
B	HYDRANT LOCATIONS AMENDED	26/05/16	TL
A	DRIVEWAYS AMENDED	09/03/16	TL
REV	AMENDMENTS	DATE	APPD.

Drawn M.CAPALDO
 Date 21/08/15
 AN -
 Designed K.PHAL
 Date 21/08/15
 AN
 Verified -
 Date -
 AN
 Audited -
 Date -
 AN
 Approved -
 Date -
 AN

- Ex W - EXISTING WATER MAIN
- Ex G - EXISTING GAS MAIN
- Ex E - EXISTING ELECTRICAL CABLE
- Ex S - EXISTING SEWER MAIN & MANHOLE
- Ex T - EXISTING TELECOMM. CABLE AND PIT
- Ex P - EXISTING ELEC. POLE & O'HEAD LINES
- Ex D - EXISTING STORMWATER DRAIN & PIT
- ES - CONSTRUCTED PRE DEVELOPMENT EXISTING SURFACE LEVEL (CORNER)
- FS - FINISHED SURFACE LEVEL (CORNER)

- LEGEND**
- S - SEWER MAIN AND MANHOLE
 - G - STORMWATER DRAIN & PIT
 - SW - SW DRAIN & PIT CONSTRUCTED IN PREVIOUS STAGES
 - P - PROPERTY INLETS
 - H - HOUSE DRAIN
 - GC - GAS CONDUIT
 - W - WATER CONDUIT
 - RW - RECYCLED WATER CONDUIT
 - TC - TELECOMM. CONDUIT
 - TM - PERMANENT SURVEY MARK
 - TB - TEMPORARY BENCH MARK

- W - WATER
- RW - RECYCLED WATER
- T - TELECOMMUNICATIONS
- E - ELECTRICITY
- G - GAS
- S - STREET NAME SIGN
- RL - REGULATE LOT AT MIN 1 IN 150 DW HYDRANT
- NDW - NDW HYDRANT
- GR - GRADE OF ALLOTMENT (ALONG SIDE)
- B - BATTER (GRADE AS SPECIFIED)
- AB - ALLOTMENT PAD BOUNDARY

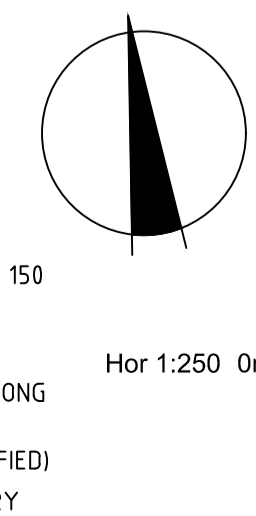

INVESTA BLOOMDALE ESTATE
 STAGE 12
 85 DAVIS ROAD, DIGGERS REST
 SALES SERVICING PLAN
 SHEET 01 OF 02
 Drawing No. 12340.12SSP01 Rev C
 Sheet No. 11 PRELIMINARY
 Coords: MGA
 Levels: AHD
 Hor 1:250 0m 2.5m 5m 10m 15m
 Scale @ A1/A3 1:250/1:500

BLOOMDALE ESTATE
 STAGE 12
 85 DAVIS ROAD, DIGGERS REST
 SALES SERVICING PLAN
 SHEET 01 OF 02
 Drawing No. 12340.12SSP01 Rev C
 Sheet No. 11 PRELIMINARY
 © Dalton Consulting Engineers Pty Ltd
 ABN 78 429 221 049

DALTON CONSULTING ENGINEERS
 ABN 78 429 221 049
 VICTORIA
 T 61 3 9813 7400
 W dceng.com.au
 QUEENSLAND
 T 61 7 3374 9000
 E info@dceng.com.au

